



StayPut™ Self-Closing Outlet Cover

Easy Installation Guide

Important:

Qdos wants to keep you and your children safe and for that we need you to do your part by carefully reading and following the instructions below.

For installation videos and FAQ go to: QdosSafety.com

Parts List:



Step 1 - Determine type of outlet



Standard Outlet

Existing cover is attached with one screw in the middle.

IMPORTANT:
Do not use with two prong ungrounded or GFCI outlets.
For indoor use only.



Decora Outlet

Existing cover is attached with two screws.

IMPORTANT:
Do not use with GFCI outlets.
For indoor use only.

Step 2 - Installation of Outlet Cover

WARNING

- Before installation turn off power to outlet.

Standard Outlet

Remove the existing wall plate.

From behind push out center screw hole cover of the Self-Closing Outlet Cover.

Place Self-Closing Outlet Cover over outlet. Place the included long screw in the center hole and tighten screw. Do not overtighten as this may cause the Cover not to slide freely or crack the plate.

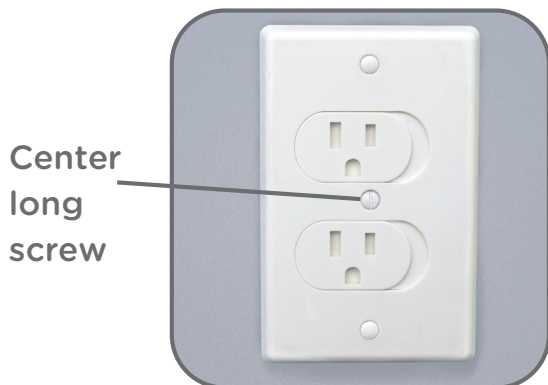

Decora Outlet

Remove the existing wall plate.

From behind push out the top and bottom screw covers of the Self-Closing Outlet Cover.

Place Self-Closing Outlet Cover over outlet. Place the included two short screws in the top and bottom holes and tighten screws. Do not overtighten as this may cause the Cover not to slide freely or crack the plate.

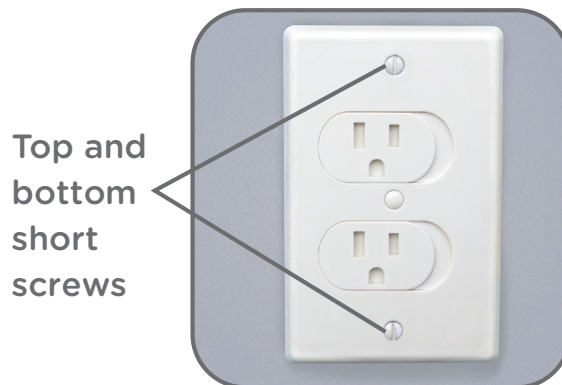

Step 3 - Test and Use of Self-Closing Outlet Cover

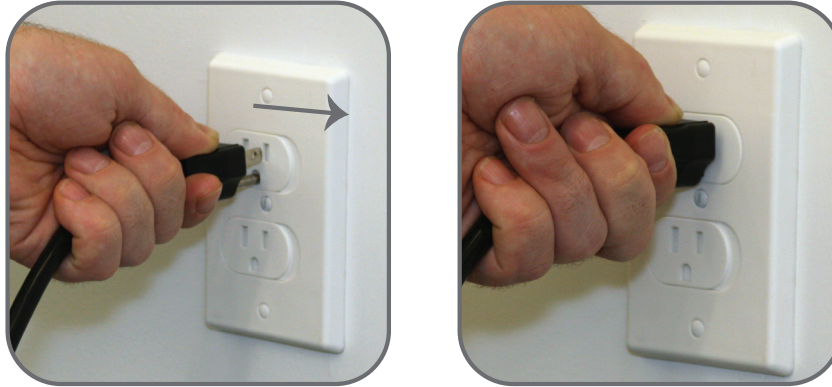

Insert plug in Self-Closing Door, slide to the right and push plug in.

Remove plug and make sure the Self-Closing Door immediately closes access to the slots.

If need be loosen screw until sliding plate moves freely.

Do not use lubricants.

Keep old cover for when Self-Closing Outlet Cover is no longer needed.