



2-in-1 Anti-Tip TV Straps

Easy 3-Step Installation Guide

Before removing the adhesive protective liner, do a dry run and test each step to make sure the installation will work. The SecureHold adhesive is meant to be used once only and cannot be repositioned if done incorrectly.

Important:

Qdos wants to keep your children safe and for that we need you to do your part by carefully reading and following the instructions below.

For installation videos and FAQs go to: QdosSafety.com

Parts List:



Step 1 - Attaching Straps to the TV

Pull the furniture out from the wall. Release all the Cam Locks and extend the straps to the maximum length. Locate the upper VESA mounting holes on the back of the TV and select the correct bolt size to fit the holes. Attach both TV Mounting Plates.

Step 2 - Positioning and attaching the Wall Brackets

There are two options for attaching the Wall Brackets.(2A) The Zero-Screw option into hollow drywall using the SecureHooks™ or (2B) with screws into a stud. For installation into any other wall material, use only the appropriate hardware for that material. Consult a professional baby proofer, a handyman or hardware store for advice.

2A -Insert SecureHooks™ into hollow drywall

Use a stud finder to locate the studs in the wall behind the TV and mark the inside edges of the studs at the height of the furniture. The “safe zone” for the SecureHooks™ to rotate properly is 3.5” from each stud as seen in the drawing.

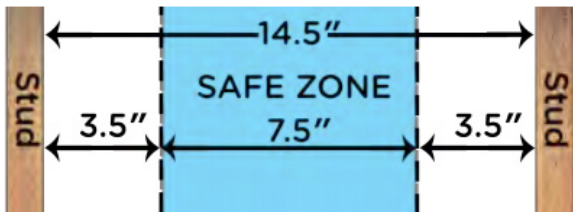

Line up the straps as straight as possible from the TV while securing the Wall Bracket, while making sure it's positioned within the “safe zone.” Now

mark the location 12” down from the top edge of the furniture. Next peel the protective liner from the adhesive* and position the first Wall Bracket in the desired location with the strap pointing upwards.

Insert the point of one of the SecureHooks™ in the upper right hole in the Wall Bracket. While turning the SecureHook™ from side to side, apply pressure until it penetrates the drywall. Continue to feed the SecureHook™ all the way in and then turn until it locks into the Catch in the Wall Bracket. Put a second SecureHook™ through the lower left hole in the Wall Bracket and push through the drywall. This SecureHook™ will turn in the opposite direction and then lock into the Catch in the Wall Bracket.

Repeat for second Wall Bracket and then attach the Covers over the Wall Brackets while holding straps up.

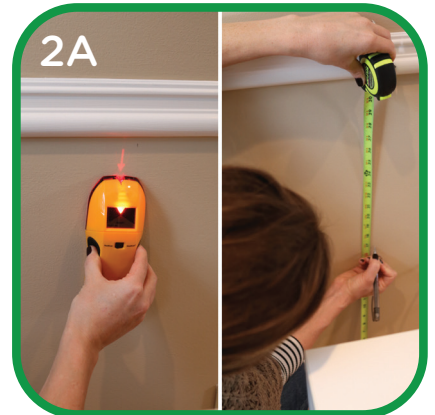

2B - Screw into Stud Behind Drywall

Locate the studs by using a stud finder. Carefully mark the center locations of each stud at the top of the furniture.

Line up the straps as straight as possible from the TV with the closest stud. Now mark that location 12" down from the top of the furniture. Double check one more time with studfinder to insure correct location. Next peel the protective liner from the adhesive* and position the Wall Brackets in the marked locations with the straps pointing upwards.

Using the included 1.5" screws, attach each Wall Bracket using the two screw holes in the center. Once screwed in attach the Covers over the Wall Brackets while holding straps up.

***IMPORTANT: The adhesive only helps to hold the Wall Bracket during installation. The Wall Bracket MUST be attached with the SecureHooks™ or screws for safety!**

Step 3 - Attaching to the Furniture

There are two options to attach the 2 in 1 Anti-Tip TV Straps to the furniture. (3A) On top of the furniture with the Zero-Screw Adhesive Furniture Plate or (3B) Screw the Cam Lock into the back of your furniture.

3A - Adhesive Furniture Plate

Line up the first Furniture Plate so it's positioned in line between the TV mounting and the Wall Bracket. Remove protective Liner and while holding the Cam Lock against the back of the furniture, fold the Furniture Plate down until it sticks. Press on it for 30 seconds for good adhesion. Do the same for the second strap on the other side.

Note: The adhesive needs to set for 24 hours for maximum adhesion.

3B - Screw into the back of the Furniture

When attaching with screws to the back of the furniture, the Furniture Plate can be removed by unscrewing the hinge pin and pulling it out. Line up the Cam Lock so it's positioned in line between the TV mounting and the Wall Bracket. Mark the hole locations and drill pilot holes using a 3/32" drill bit. Be careful not to damage the top of your furniture. Attach the Cam Locks with included 1.5" screws.

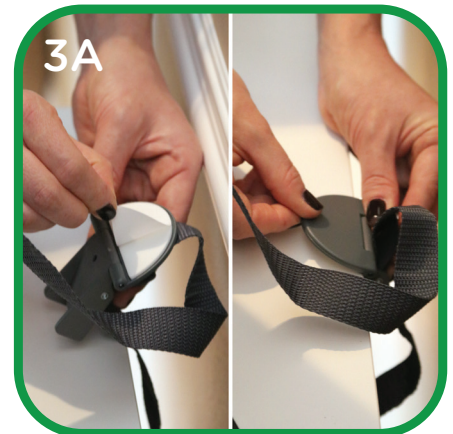
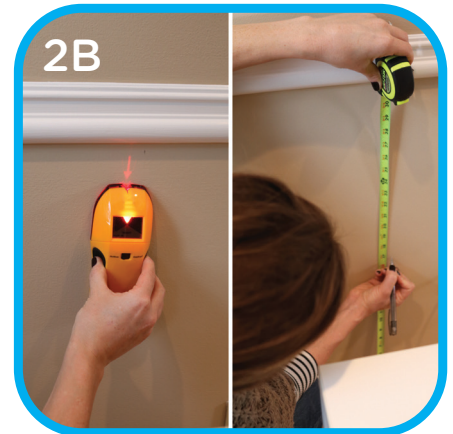

Step 4 - Taking slack out of strap

Slide Bottom Cam Lock buckles upwards toward the furniture Cam Locks to take some slack out of the straps. Finally, Push furniture back towards wall and pull upwards on the straps through the Furniture Cam Lock and lock both Furniture Cam Locks.

Slide Top Cam Locks down to take remaining slack out of the straps and push the Top Cam Locks closed.

Note: Only remove the slack, DO NOT TIGHTEN!

Cleaning Behind Furniture

In order to move the furniture out for cleaning, open up all three Cam Locks to create slack in the straps.

Permanent Removal

When permanently removing the 2 in 1 Anti-Tip TV Straps, open Cam Locks and release the straps all the way. Remove bolts from the TV and remove SecureHooks™ or screws from the Wall Brackets. Use a rounded knife and carefully lift under the front edge of the Furniture Plate until the foam tape breaks being careful not to damage your furniture surface. For remaining tape residue, use a finger to simply rub it away. If any residue still remains, use a cleaner that will not damage the surface you are removing the residue from.

